

TOOL BOX

2018

BULLET HINGES



* GREASE FITTING TYPE

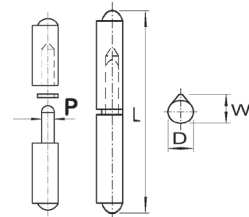
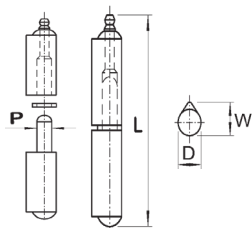

* WELD ON HINGES

BULLET HINGES MILD STEEL

CODE	MATERIAL	GREASE FITTING	L Length	P Pin Ø	D Ø	W Width	PIN Material	CTN
TB-BH0080-MB	MILD STEEL	N	80	8	13	16	BRASS	1 Only
TB-BH0100-MB	MILD STEEL	N	100	10	16	20	BRASS	1 Only
TB-BH0088-MB	MILD STEEL	Y	88	8	13	16	BRASS	1 Only
TB-BH0108-MB	MILD STEEL	Y	108	10	16	20	BRASS	1 Only

BULLET HINGES ALUMINIUM

CODE	MATERIAL	GREASE FITTING	L Length	P Pin Ø	D Ø	W Width	PIN Material	CTN
TB-BH0080-AL	ALUMINIUM	N	80	8	13	16	STAINLESS	1 Only
TB-BH0100-AL	ALUMINIUM	N	100	10	16	20	STAINLESS	1 Only
TB-BH0088-AL	ALUMINIUM	Y	88	8	13	16	STAINLESS	1 Only
TB-BH0108-AL	ALUMINIUM	Y	108	10	16	30	STAINLESS	1 Only

BULLET HINGES STAINLESS STEEL

CODE	MATERIAL	GREASE FITTING	L Length	P Pin Ø	D Ø	W Width	PIN Material	CTN
TB-BH0080-SS	STAINLESS 304	N	80	8	13	16	STAINLESS	1 Only
TB-BH0100-SS	STAINLESS 304	N	100	10	16	20	STAINLESS	1 Only
TB-BH0088-SS	STAINLESS 304	Y	88	8	13	16	STAINLESS	1 Only
TB-BH0108-SS	STAINLESS 304	Y	108	10	16	20	STAINLESS	1 Only

* ALL MEASUREMENT IN (mm).

LYNCH PIN GRIP CLIPS ZINC PLATED



CODE	DESCRIPTION	CTN
TB-B10	LENGTH = 60mm; SHAFT 10-12mm; DIA.3mm Z/P	1 Only
TB-B12	LENGTH = 65mm; SHAFT 12-22mm; DIA.4mm Z/P	1 Only
TB-B13	LENGTH = 90mm; SHAFT 16-27mm; DIA.5mm Z/P	1 Only
TB-B14	LENGTH = 110mm; SHAFT 9-32mm; DIA.6mm Z/P	1 Only
TB-B2	DIAMETER OF RING 39mm; PIN THICKNESS 6mm Z/P	1 Only
TB-B3	DIAMETER OF RING 38mm; PIN THICKNESS 8mm Z/P	1 Only
TB-B5	DIAMETER OF RING 37mm; PIN THICKNESS 9.5mm Z/P	1 Only
TB-B6	DIAMETER OF RING 40mm; PIN THICKNESS 11mm Z/P	1 Only

ALL PRICING REFER TO PRICE BOOK

PLEASE QUOTE CODES WHEN ORDERING

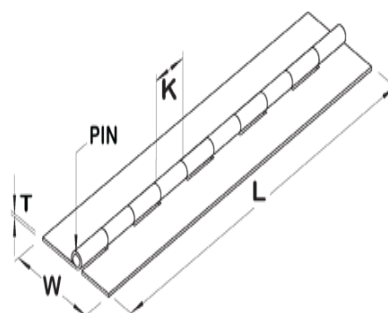

GALVANISED

CODE	W Width	T Thickness	L Length	P Pin Ø	Pin Material	K Knuckle
TB-025.1230.1800-GB	25	1.2	1800	3.0	BRASS	15
TB-032.1230.1800-GB	32	1.2	1800	3.0	BRASS	15
TB-032.1230.2400-GB	32	1.2	2400	3.0	BRASS	15
TB-038.1230.1800-GB	38	1.2	1800	3.0	BRASS	15
TB-038.1230.2400-GB	38	1.2	2400	3.0	BRASS	15
TB-050.1230.1800-GB	50	1.2	1800	3.0	BRASS	15
TB-050.1230.2400-GB	50	1.2	2400	3.0	BRASS	15
TB-057.1545.2160-GB	57	1.5	2160	4.5	BRASS	20
TB-057.1545.2400-GB	57	1.5	2400	4.5	BRASS	20

STAINLESS STEEL 304

CODE	W Width	T Thickness	L Length	P Pin Ø	Pin Material	K Knuckle
TB-032.1230.1800-SS	32	1.2	1800	3.0	304 S/S	15
TB-032.1230.2400-SS	32	1.2	2400	3.0	304 S/S	15
TB-038.1230.2400-SS	38	1.2	2400	3.0	304 S/S	15
TB-038.1230.1800-SS	50	1.2	1800	3.0	304 S/S	15
TB-050.1230.2400-SS	50	1.2	2400	3.0	304 S/S	15
TB-050.1545.1840-SS	50	1.5	1840	4.5	304 S/S	20
TB-057.1545.2160-SS	57	1.5	2160	4.5	304 S/S	20
TB-057.1545.2400-SS	57	1.5	2400	4.5	304 S/S	20

* ALL MEASUREMENT IN (mm).

POLYAMIDE HINGE

New

CODE	Finish	B Width	Thickness	A Length	P Pin Ø	E Centers	CTN
TB-7214120	Black	40	5	40	10.2	25	1 Pair
TB-7214117	Black	50	6	50	12.4	30	1 Pair

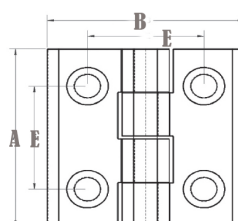

T-Locks SERIES 2000

CODE	DESCRIPTION	CTN
TB-TL2120-SS	T LOCK 2100 SERIES FLAT PAWL KEYED ALIKE OUTER PROFILE STAINLESS STEEL	1 Only
TB-TL2220-SS	T LOCK 2100 SERIES OFF-SET PAWL KEYED ALIKE OUTER PROFILE STAINLESS STEEL	1 Only

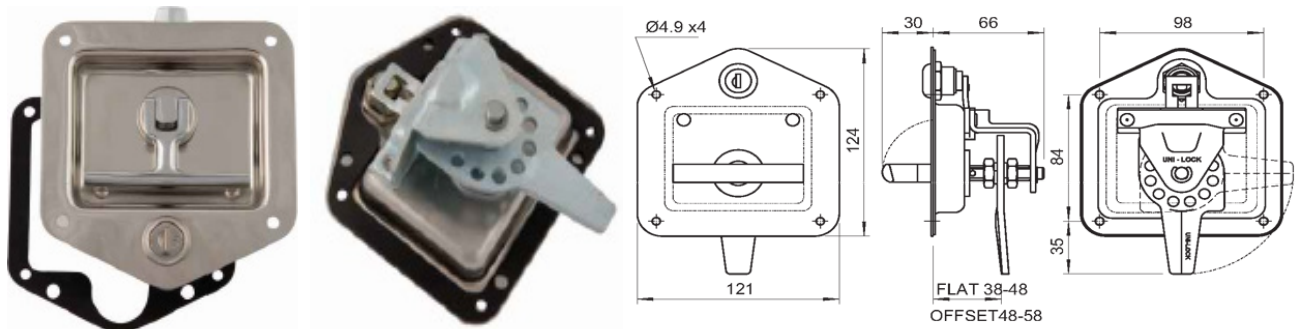

T-Lock SERIES 4000

CODE	DESCRIPTION	CTN
TB-TL4320-SS	T LOCK 4300 SERIES FLAT PAWL KEYED ALIKE OUTER PROFILE STAINLESS STEEL	1 Only
TB-TL4420-SS	T LOCK 4400 SERIES OFF-SET PAWL KEYED ALIKE OUTER PROFILE STAINLESS STEEL	1 Only

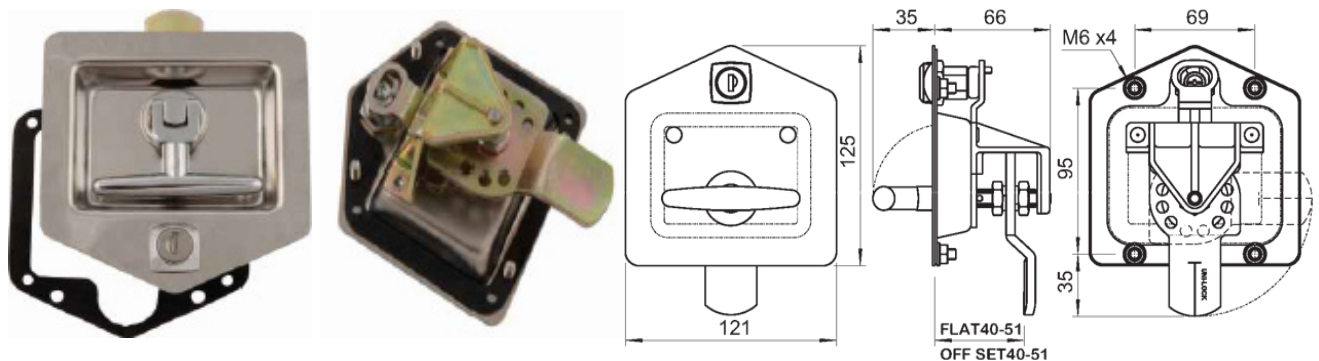

COMPRESSION LOCK SMALL



CODE	DESCRIPTION	CTN
TB-10208B-CP	SMALL COMPRESSION LOCK SATIN CHROME	1 Only
TB-10208B-BK	SMALL COMPRESSION LOCK POWDERCOATED BLACK	1 Only

New

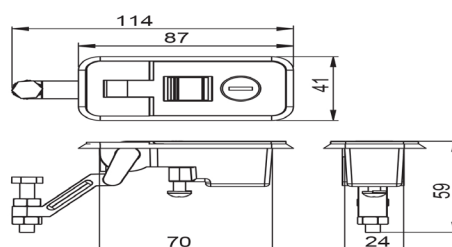

VECTOR COMPRESSION T-HANDLES

CODE	DESCRIPTION	CTN
TB-275024-06	LOCK DROP, BLACK POWDER COATED ADJUSTABLE CAM ROTATES 90° FIXING CONCEALED, GASKET INCLUDED	1 Only
TB-275021-06	LOCK DROP, BLACK POWDER COATED ADJUSTABLE CAM ROTATES 180° FRONT FIXING, GASKETS INCLUDED	1 Only

New

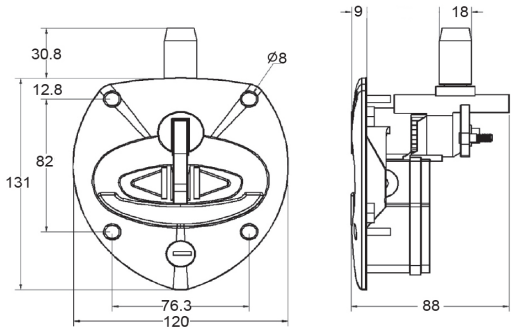
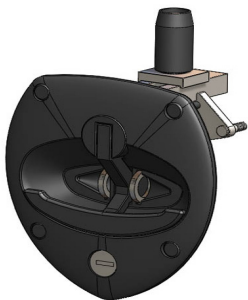

WHALE TAILS COMPRESSION ELECTRONIC ACTUATOR

CODE	DESCRIPTION	CTN
TB-EWTC140	WHALE TAILS CHROME. DESIGNED TO CONNECT IN WITH YOUR REMOTE LOCKING VEHICLE SYSTEM	1 Only
TB-EWTP140	WHALE TAIL BLACK & CHROME TAIL. DESIGNED TO CONNECT IN WITH YOUR REMOTE LOCKING VEHICLE SYSTEM	1 Only

New

! Sold as a Completed Unit Only

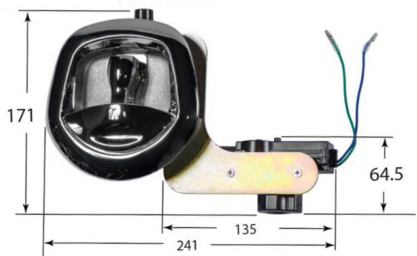
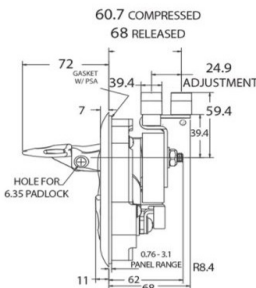
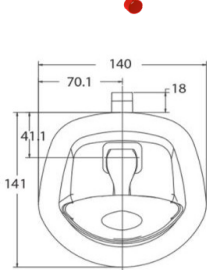

WHALE TAILS COMPRESSION LOCKS

CODE	DESCRIPTION	CTN
TB-WTC140	WHALE TAILS CHROME	1 Only
TB-WTP140	WHALE TAIL BLACK & CHROME TAIL	1 Only

New

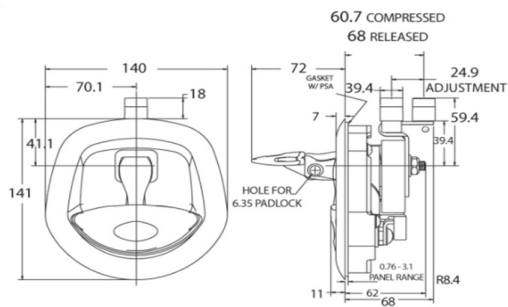

COMPRESSION LOCK

CODE	DESCRIPTION	CTN
TB-LL7380-CP	COMPRESSION LOCK SATIN CHROME	1 Only

New

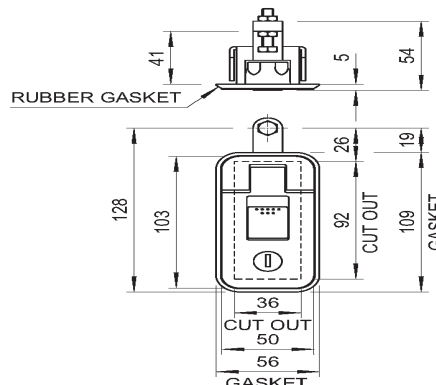

PADDLE LOCK

CODE	DESCRIPTION	CTN
TB-PL9360-SS	PADDLE KEYED ALIKE STAINLESS STEEL	1 Only
TB-PL9369-SS	PADDLE KEYED DIFFERENT STAINLESS STEEL	1 Only

New

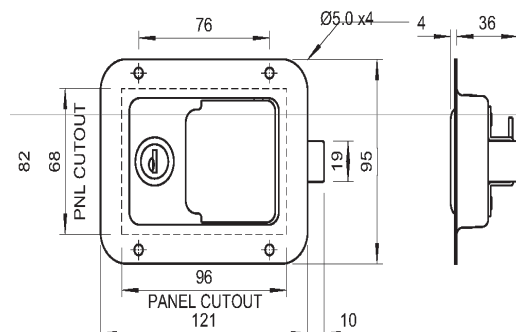

SLAM LOCK

CODE	DESCRIPTION	CTN
TB-SL9250-SS	SLAM LOCK KEYED ALIKE STAINLESS STEEL	1 Only
TB-SL9250-ZP	SLAM LOCK KEYED ALIKE ZINC PLATED	1 Only

New

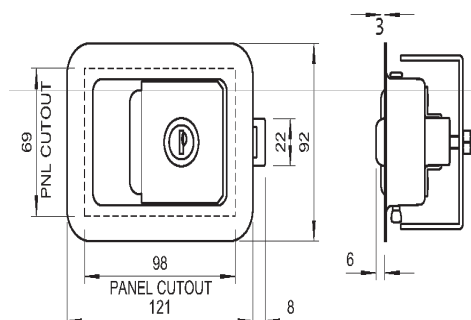

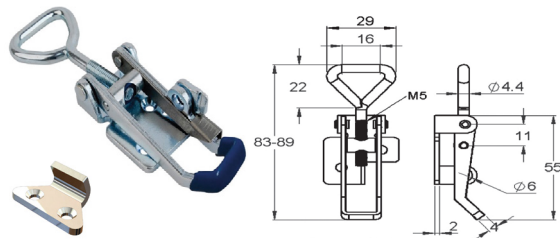
OVER CENTRE LATCH**TB-703L**

PADLOCKABLE SMALL
STRIKER INCLUDED (TB-41Z)
ZINC PLATED

1 Only

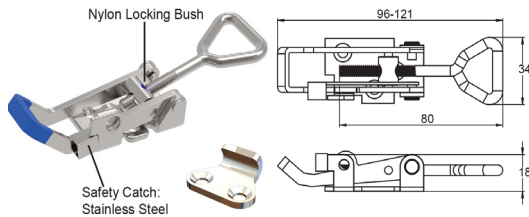
**TB-702L**

SAFETY CATCH LARGE
STRIKER INCLUDED (TB-31Z)
ZINC PLATED

1 Only

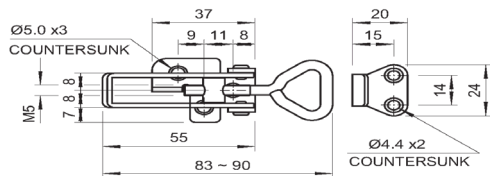
**TB-OL4120/1-ZP**

OVER CENTER LOOP LATCH SMALL ZINC
HOOK PLATED INC. (N021)

1 Only

TB-OL4120/1-SS

OVER CENTER LOOP LATCH SMALL
STAINLESS HOOK PLATE INC. (N021)

1 Only

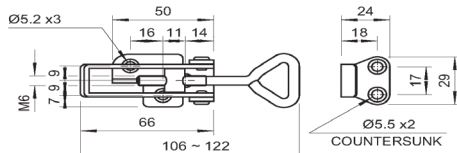
**TB-OL4130/1-ZP**

OVER CENTER LOOP LATCH MEDIUM
ZINC HOOK PLATE INC. (N031)

1 Only

TB-OL4130/1-SS

OVER CENTER LOOP LATCH MEDIUM
STAINLESS HOOK PLATE INC. (N031)

1 Only

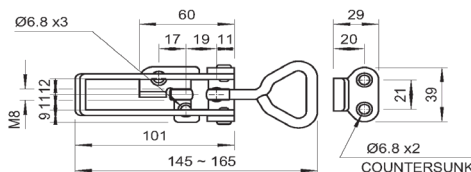
**TB-OL4140/1-ZP**

OVER CENTER LOOP LATCH LARGE
ZINC HOOK PLATE INC. (N041)

1 Only

TB-OL4140/1-SS

OVER CENTER LOOP LATCH LARGE
STAINLESS HOOK PLATED INC. (N041)

1 Only

**OVER CENTRE LATCH
HEAVY DUTY****New****TB-OL6260/3-ZP**

OVER CENTER TOGGLE LATCH,
HEAVY DUTY HOOK PLAT
INCLUDED (N03) ZINC PLATED

1 Only

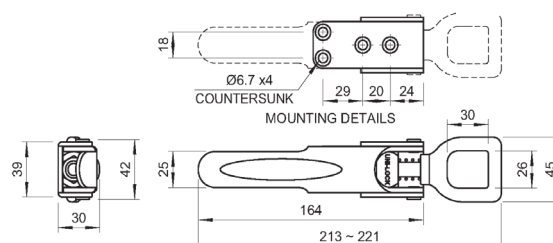

SPRING BOLTS

SPRING BOLTS



TB-SB0130-ZP

SPRING BOLT, HOLD OPEN L/H OR R/H OPERATION. ZINC

1 Only

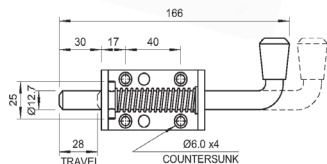

TB-SB0130-SS

SPRING BOLT, HOLD OPEN L/H OR R/H OPERATION. STAINLESS STEEL

1 Only

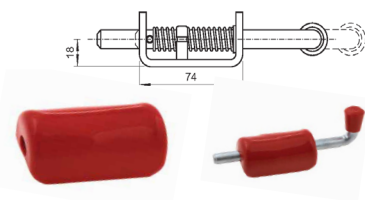

TB-SB0135-RD

SPRING BOLT COVER SUIT SB0130 RED

1 Only



CODE

DESCRIPTION

CTN

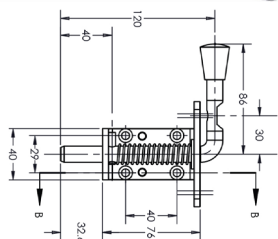

TB-9589

SPRING BOLT PADLOCKABLE FROM BOLT SIDES ZINC PLATED

1 Only

SPRING BOLTS



TB-SB0051-ZP

SPRING BOLT, LEFT HAND ZINC PLATED

1 Only

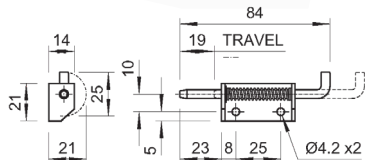

TB-SB0051-SS

SPRING BOLT, LEFT HAND STAINLESS STEEL

1 Only

New



TB-SB0052-ZP

SPRING BOLT, RIGHT HAND ZINC PLATED

1 Only

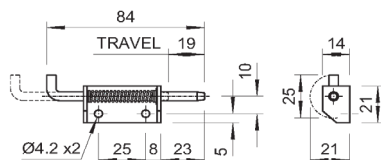

TB-SB0052-SS

SPRING BOLT, RIGHT HAND STAINLESS STEEL

1 Only

ALL PRICING REFER TO PRICE BOOK

PLEASE QUOTE CODES WHEN ORDERING

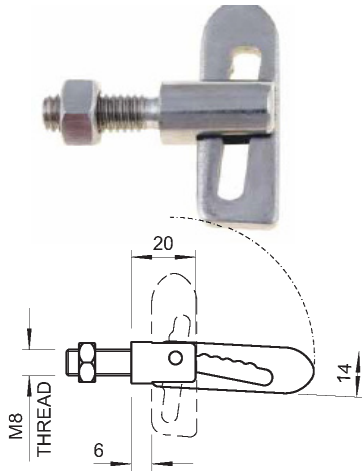
BABY ANTI-RATTLE FASTENERS

CODE	DESCRIPTION	CTN
TB-AR0020-ZP	BABY ANTI-RATTLE M8x20mm ZINC PLATED	10
TB-AR0020-SS	BABY ANTI-RATTLE M8x20mm STAINLESS STEEL	10

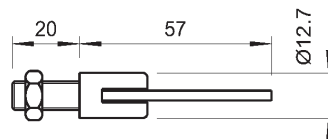
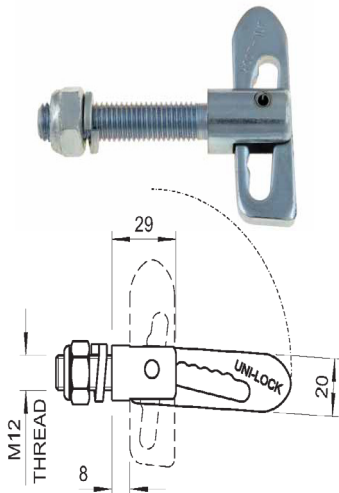
**ANTI-RATTLE FASTENERS
200 SERIES**

CODE	DESCRIPTION	CTN
TB-AR2030-ZP	ANTI-RATTLE 200 SERIES M12x 25mm ZINC PLATED	10
TB-AR2040-ZP	ANTI-RATTLE 200 SERIES M12x 60mm ZINC PLATED	10

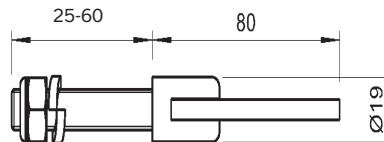
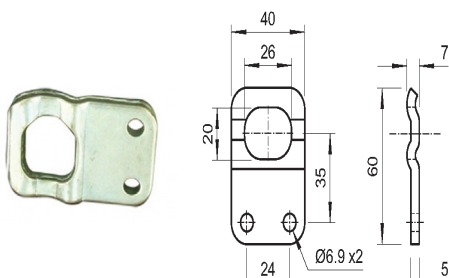
**ANTI-RATTLE ACCESSORIES
200 SERIES**

CODE	DESCRIPTION	CTN
TB-AR2150-ZP	ANTI-RATTLE KEEPER ZINC PLATED	10

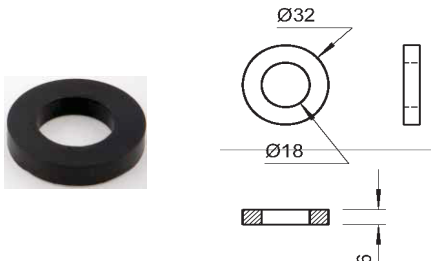

TB-AR2170	ANTI-RATTLE RUBBER WASHER BLACK 6mm THICKNESS	10
-----------	--	----

ACCESSORIES

GAS SPRING STRUTS



* MATERIAL - STEEL
* FINISH - CORROSION RESISTANCE
COATED BLACK

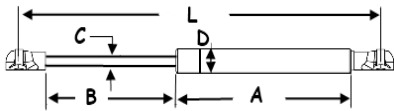

CODE	FORCE	L mm	B mm	C mm	D mm	END FITTING
TB-46017	100N	325	120	6	15	10mm
TB-46022	150N	325	120	6	15	10mm
TB-46024	200N	325	120	6	15	10mm
TB-46031	250N	325	120	6	15	10mm
TB-46038	300N	325	120	6	15	10mm
TB-46047	350N	325	120	6	15	10mm
TB-46020	100N	535	220	8	18	10mm
TB-46025	200N	535	220	8	18	10mm
TB-46035	250N	535	220	8	18	10mm
TB-46040	300N	535	220	8	18	10mm
TB-46050	350N	535	220	8	18	10mm
TB-46060	400N	535	220	8	18	10mm
TB-46070	450N	535	220	8	18	10mm
TB-46085	500N	535	220	8	18	10mm
TB-46093	600N	535	220	8	18	10mm
TB-46055	400N	820	350	10	21	13mm
TB-46080	500N	820	350	10	21	13mm
TB-46090	600N	820	350	10	21	13mm
TB-46110	700N	820	350	10	21	13mm
TB-46120	800N	820	350	10	21	13mm
TB-46130	900N	820	350	10	21	13mm



CODE	DESCRIPTION	CTN
TB-91008	BRACKET FOR GAS SPRING 10mm BALL FITTING S/S	1 Only

GAS STRUTS TIPS

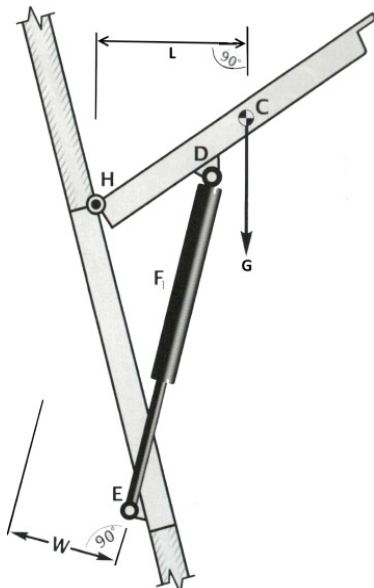

C - CENTER OF GRAVITY
D - MOVEABLE PIVOT
E - FIXED PIVOT
H - HINGE
G - WEIGHT
L - HORIZONTAL DISTANCE FROM
CENTER OF GRAVITY TO HINGE
W - EFFECTIVE LEVER ARM OF GAS
SPRING= SMALLEST DISTANCE
GAS SPRING TO HINGE E
F₁ - FORCE OF GAS SPRING

$$F_1 = \frac{G \cdot L}{W} + 10 \text{ To } 15\% \text{ SAFETY FACTOR}$$

NOTE : WHEN USING SEVERAL GAS SPRING,
F₁ IS DIVIDED BY THE NUMBER OF GAS SPRINGS.

Suggested Guide Only