

**CAPS**

**ADJUST A FOOT & CASTORS**

**2018**

## ADJUST A FOOT

## BALL JOINTED

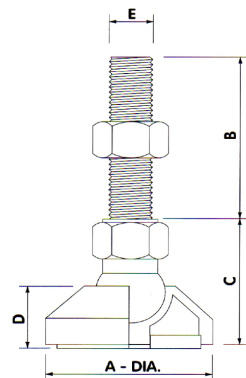

## BALL DOWN

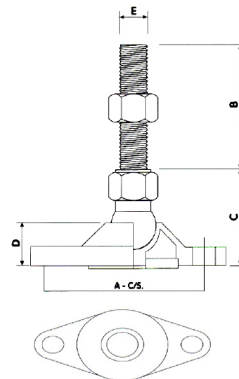

## FIXED

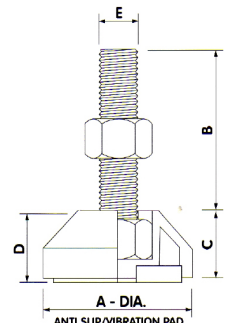

## BALL DOWN

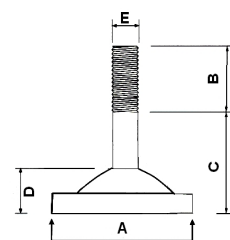

| CODE                        | SIZE   | A  | B  | C  | D  | E   | RATED |
|-----------------------------|--------|----|----|----|----|-----|-------|
| AF-40-M8-BJ                 | 40xM8  | 40 | 35 | 33 | 20 | M8  | 350   |
| AF-40-M8-BJL                | 40xM8  | 40 | 60 | 33 | 20 | M8  | 350   |
| AF-40-M10-BJ                | 40xM10 | 40 | 35 | 33 | 20 | M10 | 500   |
| AF-40-M10-BJL               | 40xM10 | 40 | 60 | 33 | 20 | M10 | 500   |
| AF-60-M12-BJ                | 60xM12 | 60 | 65 | 51 | 25 | M12 | 800   |
| AF-60-M16-BJ                | 60xM16 | 60 | 65 | 51 | 25 | M16 | 1000  |
| *Mild Steel Nut & Bolt      |        |    |    |    |    |     | 20    |
| AF-40-M8-BJS                | 40xM8  | 40 | 80 | 33 | 20 | M8  | 350   |
| AF-40-M10-BJS               | 40xM10 | 40 | 60 | 33 | 20 | M10 | 500   |
| AF-60-M12-BJS               | 60xM12 | 60 | 65 | 51 | 25 | M12 | 800   |
| AF-90-M12-BJS               | 90xM12 | 90 | 65 | 51 | 25 | M12 | 800   |
| *Stainless Steel Nut & Bolt |        |    |    |    |    |     | 21    |

|                             |        |    |    |    |    |     |      |
|-----------------------------|--------|----|----|----|----|-----|------|
| AF-60-M12-BD                | 60xM12 | 80 | 65 | 51 | 23 | M12 | 800  |
| AF-60-M16-BD                | 60xM16 | 80 | 65 | 51 | 23 | M16 | 1000 |
| *Mild Steel Nut & Bolt      |        |    |    |    |    |     | 30   |
| AF-60-M12-BDS               | 60xM12 | 80 | 65 | 51 | 23 | M12 | 800  |
| AF-60-M16-BDS               | 60xM16 | 80 | 65 | 51 | 23 | M16 | 1000 |
| AF-90-M12-BDS               | 90xM12 | 60 | 65 | 51 | 25 | M12 | 800  |
| AF-90-M16-BDS               | 90xM16 | 60 | 65 | 51 | 25 | M16 | 800  |
| *Stainless Steel Nut & Bolt |        |    |    |    |    |     | 31   |

|                             |        |    |    |   |    |     |     |
|-----------------------------|--------|----|----|---|----|-----|-----|
| AF-40-M8-F                  | 40xM8  | 40 | 35 | - | 20 | M8  | 350 |
| AF-40-M10-F                 | 40xM10 | 40 | 35 | - | 20 | M10 | 500 |
| AF-40-M10-FL                | 40xM10 | 40 | 95 | - | 20 | M10 | 500 |
| AF-60-M12-FL                | 40xM12 | 60 | 60 | - | 25 | M12 | 800 |
| *Mild Steel Nut & Bolt      |        |    |    |   |    |     | 40  |
| AF-40-M8-SF                 | 40xM8  | 40 | 35 | - | 20 | M8  | 350 |
| AF-40-M10-SF                | 40xM10 | 40 | 35 | - | 20 | M10 | 500 |
| AF-60-M12-SF                | 40xM12 | 60 | 60 | - | 25 | M12 | 850 |
| *Stainless Steel Nut & Bolt |        |    |    |   |    |     | 41  |

|                  |        |    |    |    |   |     |   |
|------------------|--------|----|----|----|---|-----|---|
| SSFOOT/M12       | 38xM12 | 38 | 38 | 35 | 5 | M12 | - |
| SSFOOT/M16       | 65xM16 | 65 | 40 | 65 | 6 | M16 | - |
| *Stainless Steel |        |    |    |    |   |     |   |

- **A-Just-Foot Is A Multi Adjustable Pedestal Foot, Ideal For Industrial, Commercial, Workshop.**

ALL PRICING REFER TO PRICE BOOK

PLEASE QUOTE CODES WHEN ORDERING

## ADJUST A FOOT

## INSERTS

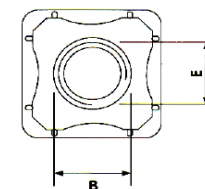
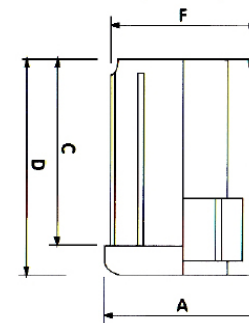

## INSERTS

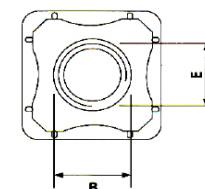
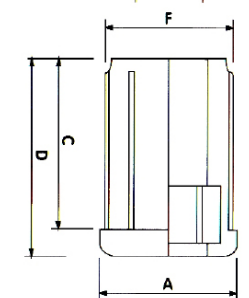

| CODE               | SIZE   | A  | B   | C  | D  | E    | F    | G     | RATED |
|--------------------|--------|----|-----|----|----|------|------|-------|-------|
| AF-25S-M8          | 25xM8  | 25 | M8  | 39 | 44 | 10   | 23.5 | 22-23 | 250   |
| AF-25S-M10         | 25xM10 | 25 | M10 | 39 | 44 | 11   | 23.5 | 22-23 | 250   |
| AF-25S-M12         | 25xM12 | 25 | M12 | 39 | 44 | 13   | 23.5 | 22-23 | 250   |
| AF-25S-M16         | 25xM16 | 25 | M16 | 39 | 44 | 16.5 | 23.5 | 22-23 | 250   |
| AF-30S-M8          | 30xM8  | 30 | M8  | 39 | 45 | 10   | 26.8 | 26-27 | 350   |
| AF-30S-M10         | 30xM10 | 30 | M10 | 39 | 45 | 11   | 26.8 | 26-27 | 350   |
| AF-30S-M12         | 30xM12 | 30 | M12 | 39 | 45 | 13   | 26.8 | 26-27 | 350   |
| AF-30S-M16         | 30xM16 | 30 | M16 | 39 | 45 | 16.5 | 26.8 | 26-27 | 350   |
| AF-32S-M8          | 32xM8  | 32 | M8  | 39 | 45 | 10   | 30   | 28-29 | 350   |
| AF-32S-M10         | 32xM10 | 32 | M10 | 39 | 45 | 11   | 30   | 28-29 | 350   |
| AF-32S-M12         | 32xM12 | 32 | M12 | 39 | 45 | 13   | 30   | 28-29 | 350   |
| AF-32S-M16         | 32xM16 | 32 | M16 | 39 | 45 | 16.5 | 30   | 28-29 | 350   |
| AF-38S-M10         | 38xM10 | 38 | M10 | 41 | 45 | 12   | 36   | 35-36 | 500   |
| AF-38S-M12         | 38xM12 | 38 | M12 | 41 | 45 | 13   | 36   | 35-36 | 500   |
| AF-38S-M16         | 38xM16 | 38 | M16 | 41 | 45 | 18   | 36   | 35-36 | 500   |
| AF-40S-M10         | 40xM10 | 40 | M10 | 39 | 45 | 11   | 36.8 | 36-37 | 350   |
| AF-40S-M12         | 40xM12 | 40 | M12 | 39 | 45 | 13   | 36.8 | 36-37 | 350   |
| AF-40S-M16         | 40xM16 | 40 | M16 | 39 | 45 | 16.5 | 36.8 | 36-37 | 500   |
| AF-51S-M10         | 51xM10 | 51 | M10 | 39 | 47 | 11   | 48   | 47-48 | 750   |
| AF-51S-M12         | 51xM12 | 51 | M12 | 39 | 47 | 13   | 48   | 47-48 | 750   |
| AF-51S-M16         | 51xM16 | 51 | M16 | 39 | 47 | 18   | 48   | 47-48 | 10750 |
| *Mild Steel Insert |        |    |     |    |    |      |      |       |       |

| CODE                    | SIZE   | A  | B   | C  | D  | E    | F    | G     | RATED |
|-------------------------|--------|----|-----|----|----|------|------|-------|-------|
| AF-25SS-M8              | 25xM8  | 25 | M8  | 39 | 44 | 10   | 23.5 | 22-23 | 250   |
| AF-25SS-M10             | 25xM10 | 25 | M10 | 39 | 44 | 11   | 23.5 | 22-23 | 250   |
| AF-25SS-M12             | 25xM12 | 25 | M12 | 39 | 44 | 13   | 23.5 | 22-23 | 250   |
| AF-25SS-M16             | 25xM16 | 25 | M16 | 39 | 44 | 16.5 | 23.5 | 22-23 | 250   |
| AF-30SS-M8              | 30xM8  | 30 | M8  | 39 | 45 | 10   | 26.8 | 26-27 | 350   |
| AF-30SS-M10             | 30xM10 | 30 | M10 | 39 | 45 | 11   | 26.8 | 26-27 | 350   |
| AF-30SS-M12             | 30xM12 | 30 | M12 | 39 | 45 | 13   | 26.8 | 26-27 | 350   |
| AF-32SS-M8              | 32xM8  | 32 | M8  | 39 | 45 | 10   | 30   | 28-29 | 350   |
| AF-32SS-M10             | 32xM10 | 32 | M10 | 39 | 45 | 11   | 30   | 28-29 | 350   |
| AF-32SS-M12             | 32xM12 | 32 | M12 | 39 | 45 | 13   | 30   | 28-29 | 350   |
| AF-32SS-M16             | 32xM16 | 32 | M16 | 39 | 45 | 16.5 | 30   | 28-29 | 350   |
| AF-38SS-M10             | 38xM10 | 38 | M10 | 41 | 47 | 17.7 | 36   | 35-36 | 500   |
| AF-38SS-M12             | 38xM12 | 38 | M12 | 41 | 47 | 13   | 36   | 35-36 | 500   |
| AF-40SS-M10             | 40xM10 | 40 | M10 | 39 | 45 | 11   | 36.8 | 36-37 | 500   |
| AF-40SS-M12             | 40xM12 | 40 | M12 | 39 | 45 | 13   | 36.8 | 36-37 | 500   |
| AF-51SS-M10             | 51xM10 | 51 | M10 | 39 | 45 | 11   | 48   | 47-48 | 750   |
| AF-51SS-M12             | 51xM12 | 51 | M12 | 39 | 45 | 13   | 48   | 47-48 | 750   |
| AF-51SS-M16             |        | 51 | M16 | 39 | 45 | 18   | 48   | 47-48 | 750   |
| *Stainless Steel Insert |        |    |     |    |    |      |      |       | 11    |

\*(G) is recommended ID tube size

ALL PRICING REFER TO PRICE BOOK

PLEASE QUOTE CODES WHEN ORDERING

UTILITY SERIES  
PLATE CASTOR

Up To 70 kg

Plate mounted, Richmond's Utility Castor has endless light duty applications, adding mobility to many useful items including wire baskets, display equipment and light trolley applications.

Its zinc plated, pressed metal construction provides an attractive corrosion resistant finish. Together with a choice of nylon or grey non-marking wheels, this castor is truly a utility by name and nature, a must have for all small fabricating, retail and home handy man purposes.



New

S3710B

SPECIFICATIONS & FITTING

| CODE Rigid | CODE Swivel | Diameter mm | Width mm | Wheel Type  | Wheel Code | Bearing Type | Load Capacity | Height mm | Swivel Radius | With Brake |
|------------|-------------|-------------|----------|-------------|------------|--------------|---------------|-----------|---------------|------------|
| R2711      | S2710       | 50          | 20       | Inst Rubber | -          | Ball         | 30/25         | 69        | 50            | 77         |
| R2709      | S2708       | 50          | 20       | Nylon       | -          | Plain        | 30/25         | 69        | 50            | 77         |
| R3711      | S3710       | 75          | 25       | Inst Rubber | IR3301     | Ball         | 50/40         | 98        | 65            | 85         |
| R3709      | S3708       | 75          | 25       | Nylon       | NY3324     | Plain        | 50/40         | 98        | 65            | 85         |
| R4711      | S4710       | 100         | 25       | Inst Rubber | IR4401     | Ball         | 70/60         | 134       | 90            | 100        |
| R4717      | S4716       | 100         | 25       | Nylon       | NY4415     | Plain        | 70/60         | 134       | 90            | 100        |



**BRAKE OPTIONS:**  
B= BRAKE, To ORDER CASTOR WITH BRAKE ADD B To END Of SWIVEL CODE EG: S3710B  
**LOAD CAPACITY:**  
FIRST FIGURE RIGID, SECOND FIGURE SWIVEL

BASE PLATE DIMENSION & DRILLING PATTERNS FOR SWIVEL & RIGID CASTOR

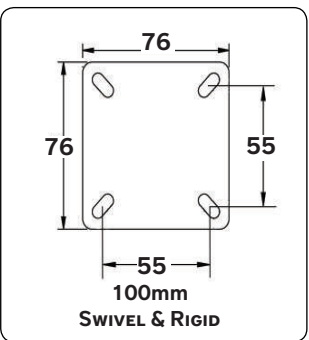
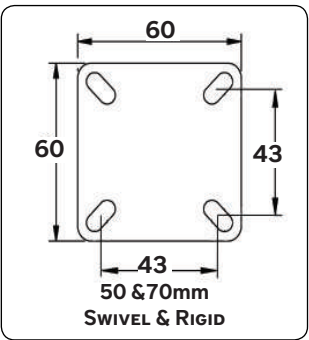

S3708B



New

RR- Rebound Rubber  
IR- Institutional Rubber  
PU- Polyurethane  
CI- Cast Iron  
NY- Nylon

UTILITY SERIES  
BOLT CASTOR

Up To 70 kg

Ideal for light duty applications including wire baskets, display equipment and light trolley applications, Richmond's Utility Series Bolt Castor's offers a corrosion resistant attractive zinc plated finish in a pressed metal construction. A choice of a nylon wheel or non-marking grey rubber adds to the versatility of this castor.

The ability to add various pintle fittings for round or square tubing ensures maximum functionality and performance.



New

S3714B

SPECIFICATIONS & FITTING

| CODE Swivel | Diameter mm | Width mm | Wheel Type  | Wheel Code | Bearing Type | Load Capacity | Height mm | Swivel Radius | With Brake | Bolt Hole Size (mm) |
|-------------|-------------|----------|-------------|------------|--------------|---------------|-----------|---------------|------------|---------------------|
| S2714       | 50          | 20       | Inst Rubber | -          | Ball         | 30/20         | 68        | 49            | 75         | 10                  |
| S2712       | 50          | 20       | Nylon       | -          | Plain        | 30/20         | 68        | 49            | 75         | 10                  |
| S3714       | 75          | 25       | Inst Rubber | IR3301     | Ball         | 50/40         | 98        | 65            | 85         | 10                  |
| S3712       | 75          | 25       | Nylon       | NY3324     | Plain        | 50/40         | 98        | 65            | 85         | 10                  |
| S4714       | 100         | 25       | Inst Rubber | IR4401     | Ball         | 70/60         | 131       | 90            | 100        | 10                  |
| S4712       | 100         | 25       | Nylon       | NY4415     | Plain        | 70/60         | 131       | 90            | 100        | 10                  |



**BRAKE OPTIONS:**  
B= BRAKE, To ORDER CASTOR WITH BRAKE ADD B To END Of SWIVEL CODE EG: S3714B  
**LOAD CAPACITY:**  
FIRST FIGURE RIGID, SECOND FIGURE SWIVEL

NYLON EXPANDING  
PINTLES



| CODE Pintle | Pintle Type               |
|-------------|---------------------------|
| UTI10-P1    | For 19mm ID Round Type    |
| UTI10-P2    | For 22mm ID Round Type    |
| UTI10-P3    | For 28.5mm ID Round Type  |
| UTI10-P4    | For 19mm ID Square Type   |
| UTI10-P5    | For 22mm ID Square Type   |
| UTI10-P6    | For 28.5mm ID Square Type |

CASTOR FITTING REQUIREMENTS

To fit this castor to a 20mm thick base requires a 40mm x 10mm set screw. Reduction Bushes available to allow fitting with a 8 mm Set Screw

REDUCTION BUSHES

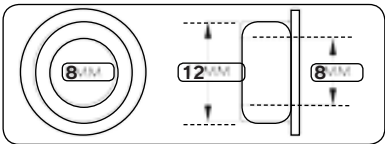

8mm FITTING  
CODE: 100RED1008UTI

BOLT FOR CASTOR

SINGLE BOLT FITTINGS 10mm VARIOUS BOLTS  
LENGTH AVAILABLE

CHOOSE WHEN ORDERING

New



S3712



UTILITY SERIES  
PLATE CASTOR

Up To 70 kg

Plate mounted, Richmond's Utility Castor has endless light duty applications, adding mobility to many useful items including wire baskets, display equipment and light trolley applications.

Its zinc plated, pressed metal construction provides an attractive corrosion resistant finish. Together with a choice of nylon or grey non-marking wheels, this castor is truly a utility by name and nature, a must have for all small fabricating, retail and home handy man purposes.



S3710B

SPECIFICATIONS & FITTING

| CODE Rigid | CODE Swivel | Diameter mm | Width mm | Wheel Type  | Wheel Code | Bearing Type | Load Capacity | Height mm | Swivel Radius | With Brake |
|------------|-------------|-------------|----------|-------------|------------|--------------|---------------|-----------|---------------|------------|
| R2711      | S2710       | 50          | 20       | Inst Rubber | -          | Ball         | 30/25         | 69        | 50            | 77         |
| R2709      | S2708       | 50          | 20       | Nylon       | -          | Plain        | 30/25         | 69        | 50            | 77         |
| R3711      | S3710       | 75          | 25       | Inst Rubber | IR3301     | Ball         | 50/40         | 98        | 65            | 85         |
| R3709      | S3708       | 75          | 25       | Nylon       | NY3324     | Plain        | 50/40         | 98        | 65            | 85         |
| R4711      | S4710       | 100         | 25       | Inst Rubber | IR4401     | Ball         | 70/60         | 134       | 90            | 100        |
| R4717      | S4716       | 100         | 25       | Nylon       | NY4415     | Plain        | 70/60         | 134       | 90            | 100        |

**!** BRAKE OPTIONS:  
B= BRAKE, To ORDER CASTOR WITH BRAKE ADD B To END Of SWIVEL CODE EG: S3710B  
LOAD CAPACITY:  
FIRST FIGURE RIGID, SECOND FIGURE SWIVEL

BASE PLATE DIMENSION & DRILLING PATTERNS FOR SWIVEL & RIGID CASTOR

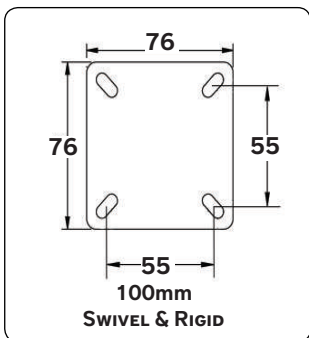
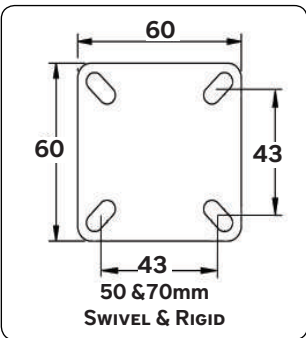

S3708B



New

RR- Rebound Rubber  
IR- Institutional Rubber  
PU- Polyurethane  
CI- Cast Iron  
NY- Nylon

UTILITY SERIES  
BOLT CASTOR

Up To 70 kg

Ideal for light duty applications including wire baskets, display equipment and light trolley applications, Richmond's Utility Series Bolt Castor's offers a corrosion resistant attractive zinc plated finish in a pressed metal construction. A choice of a nylon wheel or non-marking grey rubber adds to the versatility of this castor.

The ability to add various pintle fittings for round or square tubing ensures maximum functionality and performance.



S3714B

SPECIFICATIONS & FITTING

| CODE Swivel | Diameter mm | Width mm | Wheel Type  | Wheel Code | Bearing Type | Load Capacity | Height mm | Swivel Radius | With Brake | Bolt Hole Size (mm) |
|-------------|-------------|----------|-------------|------------|--------------|---------------|-----------|---------------|------------|---------------------|
| S2714       | 50          | 20       | Inst Rubber | -          | Ball         | 30/20         | 68        | 49            | 75         | 10                  |
| S2712       | 50          | 20       | Nylon       | -          | Plain        | 30/20         | 68        | 49            | 75         | 10                  |
| S3714       | 75          | 25       | Inst Rubber | IR3301     | Ball         | 50/40         | 98        | 65            | 85         | 10                  |
| S3712       | 75          | 25       | Nylon       | NY3324     | Plain        | 50/40         | 98        | 65            | 85         | 10                  |
| S4714       | 100         | 25       | Inst Rubber | IR4401     | Ball         | 70/60         | 131       | 90            | 100        | 10                  |
| S4712       | 100         | 25       | Nylon       | NY4415     | Plain        | 70/60         | 131       | 90            | 100        | 10                  |

**!** BRAKE OPTIONS:  
B= BRAKE, To ORDER CASTOR WITH BRAKE ADD B To END Of SWIVEL CODE EG: S3714B  
LOAD CAPACITY:  
FIRST FIGURE RIGID, SECOND FIGURE SWIVEL

NYLON EXPANDING  
PINTLES

| CODE Pintle | Pintle Type               |
|-------------|---------------------------|
| UTI10-P1    | For 19mm ID Round Type    |
| UTI10-P2    | For 22mm ID Round Type    |
| UTI10-P3    | For 28.5mm ID Round Type  |
| UTI10-P4    | For 19mm ID Square Type   |
| UTI10-P5    | For 22mm ID Square Type   |
| UTI10-P6    | For 28.5mm ID Square Type |

**CASTOR FITTING REQUIREMENTS**  
To fit this castor to a 20mm thick base requires a 40mm x 10mm set screw.  
Reduction Bushes available to allow fitting with a 8 mm Set Screw

REDUCTION BUSHES

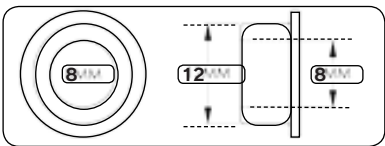

8mm FITTING  
CODE: 100RED1008UTI

BOLT FOR CASTOR

SINGLE BOLT FITTINGS 10mm VARIOUS BOLTS  
LENGTH AVAILABLE

CHOOSE WHEN ORDERING



S3712